

JAM-D Steel Zinc Plated Drop In Anchor

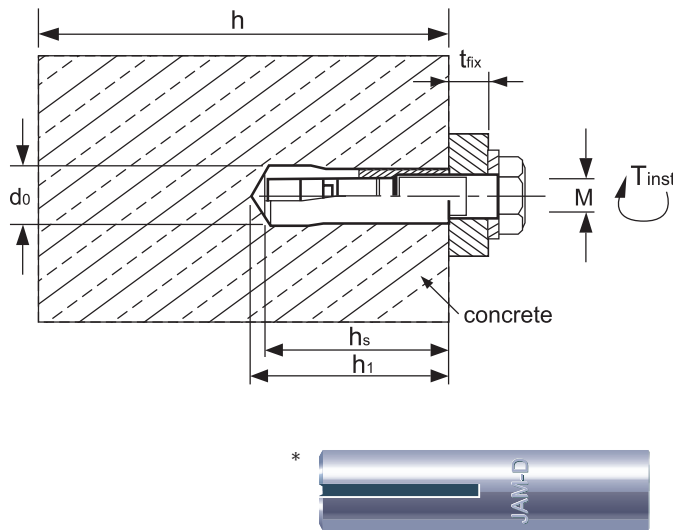

Features

- safe, fast and easy expansion
- movement controlled expansion
- short embedment

Application

- suspension threaded rod for ceiling, ventilation and sprinkler systems, steel brackets.

Material

- steel, zinc plated $\geq 5\mu\text{m}$
A4/316 stainless steel

Base material

- concrete
(Non-cracked concrete $f_{cc} = 30\text{N/mm}^2$)

Item No.	Description	Bore x Hole Depth $d_o \times h_1$ (mm)	Setting Depth h_s (mm)	Tightening Torque T_{inst} (Nm)	Base Material Thickness h (mm)	Thread $\phi \times$ Length (mm)	Tensile Load (kN)	Shear Load (kN)
2011106025	D M6 x 25	8 x 28	25	5	100	M6 x 10	1.80	2.00
2011108030	D M8 x 30	10 x 33	30	10	100	M8 x 13	3.60	3.00
2011110040	D M10 x 40	12 x 44	40	20	100	M10 x 15	4.80	4.60
2011112050	D M12 x 50	15 x 54	50	40	150	M12 x 18	7.80	8.00
2011116065	D M16 x 65	20 x 71	65	70	200	M16 x 23	11.00	12.50
2011120080	D M20 x 80	25 x 86	80	150	200	M20 x 34	12.00	18.00

JAM-D A4 Stainless Steel Drop In Anchor



Item No.	Description	Bore x Hole Depth $d_o \times h_1$ (mm)	Setting Depth h_s (mm)	Tightening Torque T_{inst} (Nm)	Base Material Thickness h (mm)	Thread $\phi \times$ Length (mm)	Tensile Load (kN)	Shear Load (kN)
2011406025	D M6 x 25 A4	8 x 28	25	5	100	M6 x 10	1.80	2.00
2011408030	D M8 x 30 A4	10 x 33	30	10	100	M8 x 13	3.60	3.00
2011410040	D M10 x 40 A4	12 x 44	40	20	100	M10 x 15	4.80	4.60
2011412050	D M12 x 50 A4	15 x 54	50	40	150	M12 x 18	7.80	8.00
2011416065	D M16 x 65 A4	20 x 71	65	70	200	M16 x 23	11.00	12.50
2011420080	D M20 x 80 A4	25 x 86	80	150	200	M20 x 34	12.00	18.00

Installation of JAM-D Drop In Anchor

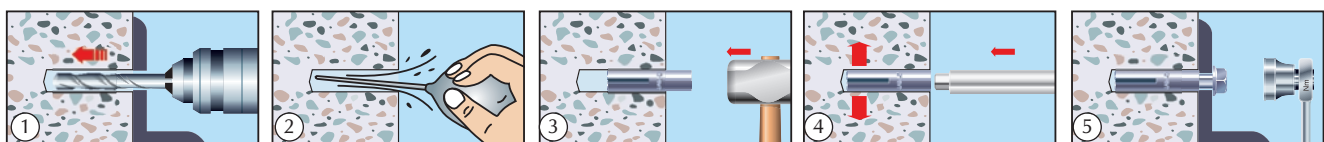

1. Drill to specified diameter and depth.
2. Clean the hole with blow-out bulb.
3. Insert anchor into the hole by hammer.
4. Install anchor using proper setting tool.
Setting tool to be driven into anchor until setting tool's shoulder meets top of anchor.
5. Use a torque wrench to apply a required tightening torque.

*Head shape of M6 & M8
**Head shape of M10 to M20